

1 2 3 4 5 6 7

SIGN	DATE	DESCRIPTION	APPROVER
△			
△			
△			

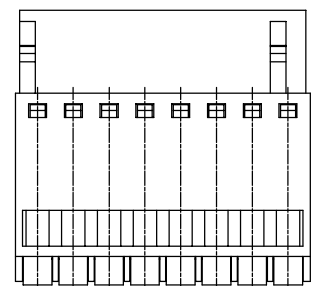
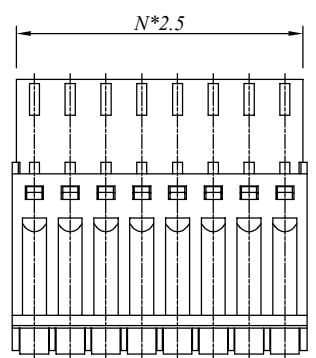
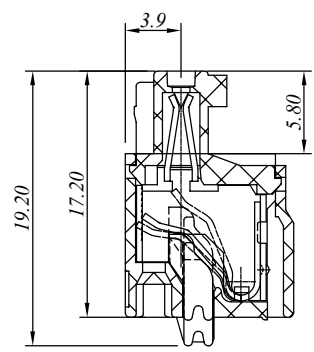
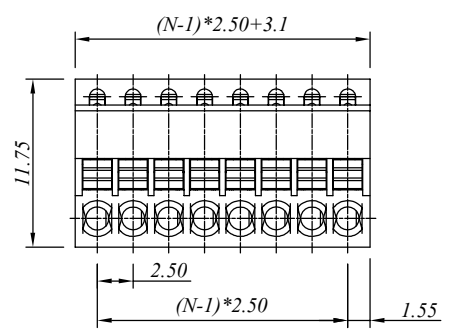
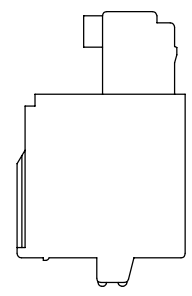
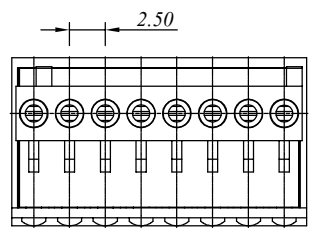

*N=Number of contacts*

**材质于电镀/ Material**

塑件/Insulator body: PA66, UL94V-0  
 弹片/Shrapnel: Stainless steel  
 夹子/Clamp: Phosphor bronze, Ni planted

**电器性能/ Electrical**

参考标准/Standard: UL IEC  
 额定电压/Rated voltage: 150V 250V  
 额定电流/Rated current: 5A 6A  
 接触电阻/Contact resistance: 20m Ω (max)  
 绝缘电阻/Insulation resistance: 500M Ω /500V  
 耐电压/Withstanding voltage: AC 2000V/1Min  
 使用线径/Wire range: 20-26AWG, 0.5mm<sup>2</sup>

**机械性能/ Mechanical**

温度范围/Temperature range: -40°C to +105°C  
 剥线长度/Steip length: 8mm

**尺寸/Dimensions**

间距/Pitch: 2.50mm  
 极数/Poles: 2-24P

**慈溪万海电子有限公司**  
**CIXI WANHAI ELECTRONICS CO., LTD.**

PART. NAME: 15EDGKD-2.5-XXP				TITLE:	
PART. NO.:				DWG NAME:	
APPROVED BY	CHECKED BY	DESIGNED BY	DRAWN BY	CUSTOM NO.:	Tolerance X ±0.50 X.X ±0.30 X.XX ±0.10 XX° ±1°
				UNITS:mm	
				SCALE:1.9/1 REVISION:5	

E  
D  
C  
B  
A