

1

2

3

4

5

6

7

SIGN	DATE	DESCRIPTION	APPROVER
△			
△			
△			

E

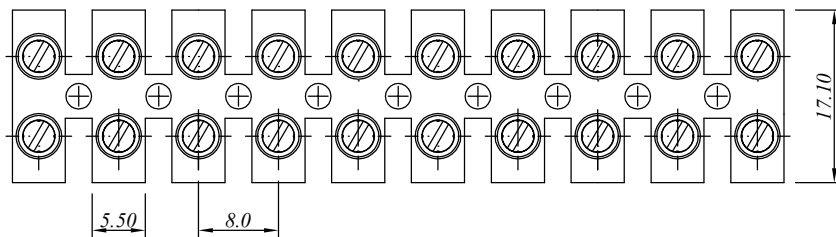

D

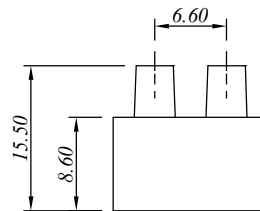
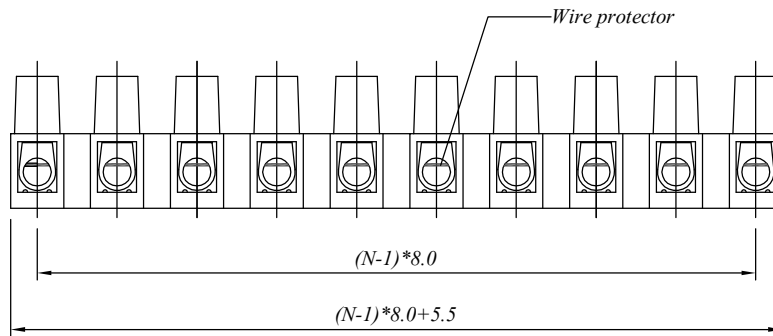

材质与电镀/ Material

塑件/Insulator body: PA66, UL94V-0  
 方块/Contact(metal housing): Brass , Ni plated  
 螺丝/Terminal screw: M2.6, Steel Zn plated

电器性能/ Electrical

额定电压/Rated voltage: 450V  
 额定电流/Rated current: 17.5A  
 耐电压/Withstanding voltage: AC 2500V/1Min  
 使用线径/Wire range: 14-20AWG, 1.5mm<sup>2</sup>

机械性能/ Mechanical

扭矩/Torque: 0.4Nm(3.6Lb.in)  
 温度范围/Temperature range: -40°C to +120°C  
 剥线长度/Steip length: 5mm

尺寸/Dimensions

间距/Pitch: 8.0mm  
 极数/Poles: 2-12P

C

B

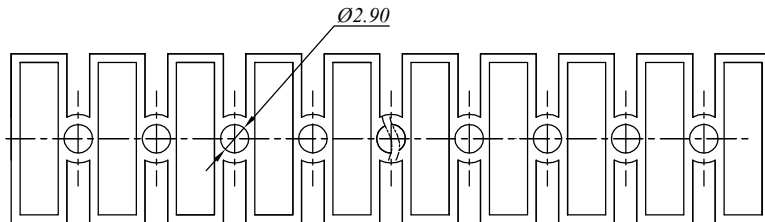

A

N=Number of contacts

慈溪万海电子有限公司  
**CIXI WANHAI ELECTRONICS CO., LTD.**

PART. NAME: PA230WP-8.0				TITLE:	
PART. NO.:				DWG NAME:	
APPROVED BY	CHECKED BY	DESIGNED BY	DRAWN BY	CUSTOM NO.:	Tolerance x. ±0.50 x.x ±0.30 x.xx ±0.10 xx° ±1°
				UNITS: mm SCALE: 4/1	