

SIGN	DATE	DESCRIPTION	APPROVER
△			
△			
△			

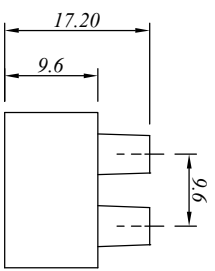
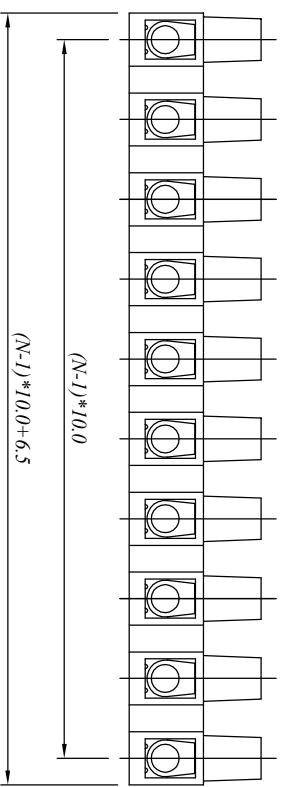
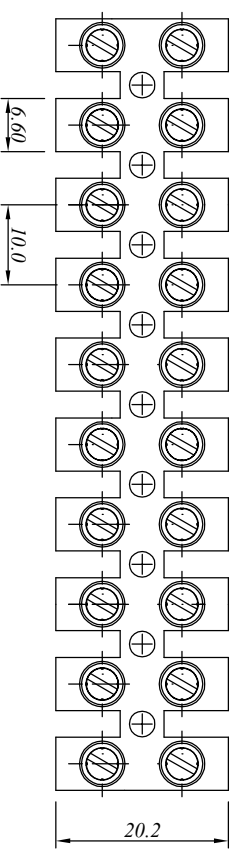

材质与电镀 / Material
 塑料 / Insulator body: P466, UL94V-0
 方块 (Contact/metal housing): Brass, Ni plated
 螺丝 / Terminal screw: M3, Steel Zn plated

电器性能 / Electrical
 额定电压 / Rated voltage: 450V
 额定电流 / Rated current: 24A
 耐电压 / Withstanding voltage: AC 2500V/1Min
 使用线径 / Wire range: 12-18AWG, 2.5mm²

机械性能 / Mechanical
 扭矩 / Torque: 3.54Lb.in
 温度范围 / Temperature range: -40°C to +120°C
 剥线长度 / Strip length: 6.5mm

尺寸 / Dimensions
 间距 / Pitch: 10.0mm
 极数 / Poles: 2-12P

N = Number of contacts

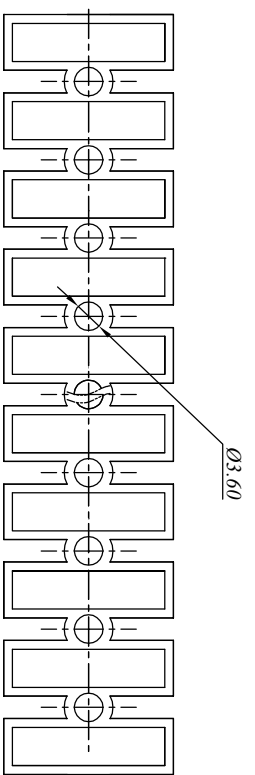

慈溪万海电子有限公司
CIXI WANHAI ELECTRONICS CO., LTD.

PART NAME: P410H-10.0		TITLE:	
PART NO.:		DWG NAME:	
APPROVED BY	CHECKED BY	DESIGNED BY	DRAWN BY
CUSTOM NO.:		UNITS: mm	
		SCALE: 4/1	
		REVISION: B3	
Tolerance		x. ±0.50	
		x.x ±0.30	
		x.xx ±0.10	
		x° ±1°	

1 2 3 4 5 6 7