

1

2

3

4

5

6

7

SIGN	DATE	DESCRIPTION	APPROVER
△			
△			
△			

E

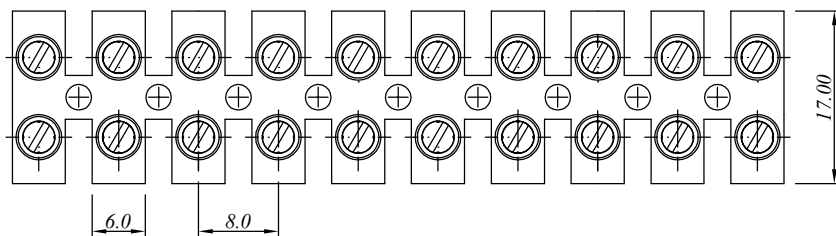

D

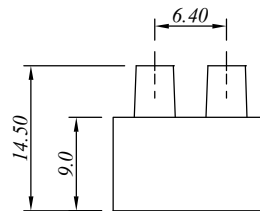
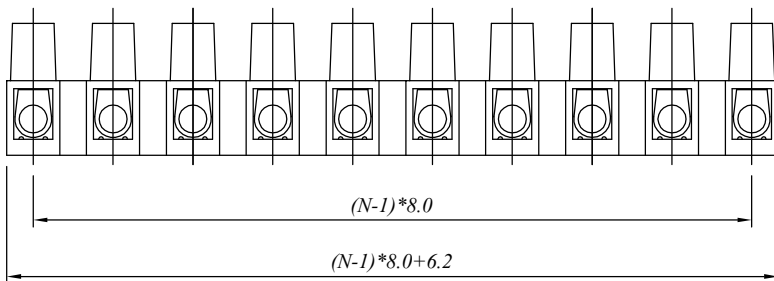

C

材质与电镀/ Material

塑件/Insulator body:

PA66, UL94V-0

方块/Contact(metal housing):

Brass , Ni plated

螺丝/Terminal screw:

M2.6, Steel Zn plated

电器性能/ Electrical

额定电压/Rated voltage:

450V

额定电流/Rated current:

17.5A

耐电压/Withstanding voltage:

AC 2500V/1Min

使用线径/Wire range:

14-20AWG, 1.5mm²

机械性能/ Mechanical

扭矩/Torque:

0.4Nm(3.6Lb.in)

温度范围/Temperature range:

-40°C to +120°C

剥线长度/Steip length:

5mm

尺寸/Dimensions

间距/Pitch:

8.0mm

极数/Poles:

2-12P

B

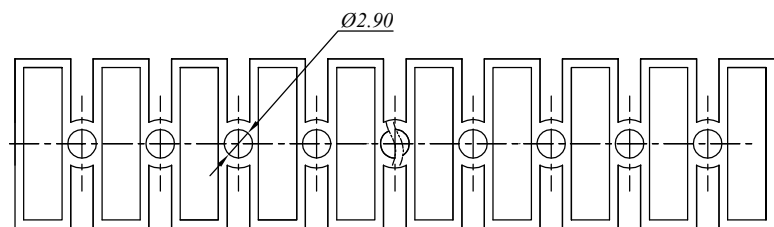

A

N=Number of contacts

慈溪万海电子有限公司
CIXI WANHAI ELECTRONICS CO., LTD.

PART. NAME: PA8H				TITLE:	
PART. NO.:				DWG NAME:	
APPROVED BY	CHECKED BY	DESIGNED BY	DRAWN BY	CUSTOM NO.:	Tolerance x. ±0.50 x.x ±0.30 x.xx ±0.10 xx° ±1°
				 UNITS: mm SCALE: 4/1 REVISION:B3	