

P.C.B. LAYOUT

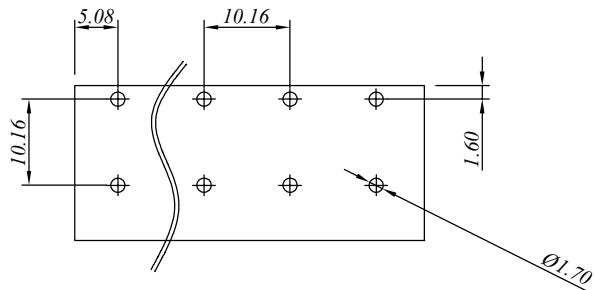
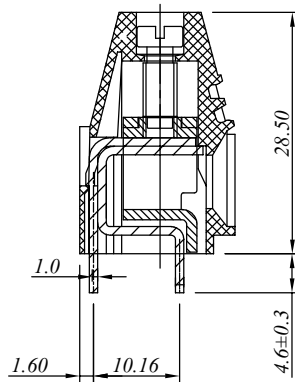
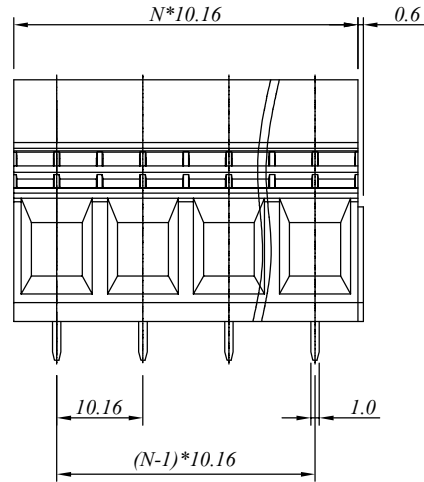

N=Number of contacts

△			
△			
△			

材质于电镀/Material

塑件/Insulator body:

PA66, UL94V-0

方块/Contact(metal housing):

Brass ,Ni planted

螺丝/Terminal screw:

M4.0, Steel Zn planted

焊脚/Pin header:

Brass, Tin planted

电器性能/Electrical

参考标准/Standard:

UL IEC

额定电压/Rated voltage:

300V 1000V

额定电流/Rated current:

60A 57A

接触电阻/Contact resistance:

20m Ω (max)

绝缘电阻/Insulation resistance:

500M Ω /500V

耐电压/Withstanding voltage:

AC 2000V/1Min

使用线径/Wire range:

6-20AWG, 10.0mm²

机械性能/Mechanical

扭矩/Torque:

1.2Nm(10.5Lb.in)

温度范围/Temperature range:

-40°C to +105°C

剥线长度/Steip length:

10-11mm

瞬间温度/Max soldering:

+250°C, for 5 Sec

尺寸/Dimensions

间距/Pitch:

10.16mm

极数/Poles:

2-24P

慈溪万海电子有限公司 CIXI WANHAI ELECTRONICS CO., LTD.

PART. NAME: JM1016-10.16-XXP

TITLE:

PART. NO.:

DWG NAME:

APPROVED BY

CHECKED BY

DESIGNED BY

DRAWN BY

CUSTOM NO.:

Tolerance

X ±0.50

X.X ±0.30

X.XX ±0.10

XX° ±1°



UNITS: mm

SCALE: 3.125/1

REVISION B2