

1

2

3

4

5

6

7

SIGN	DATE	DESCRIPTION	APPROVER
△			
△			
△			

P.C.B. LAYOUT

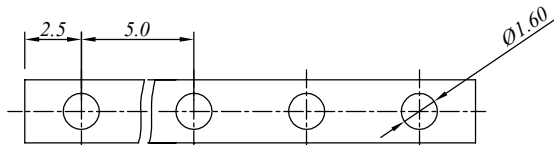
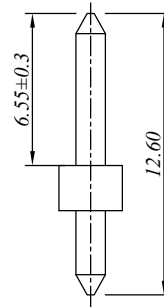
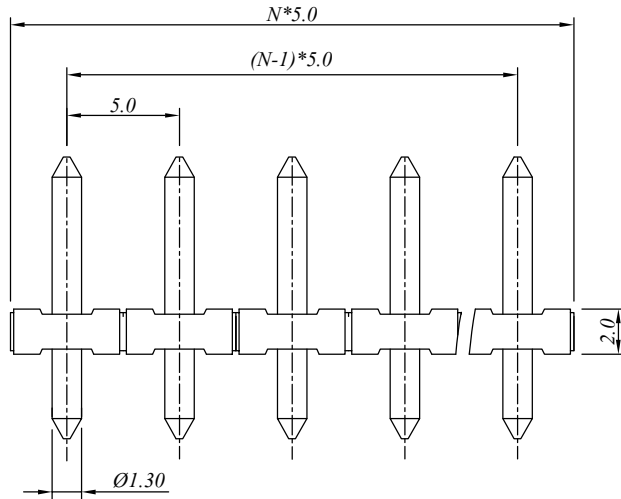
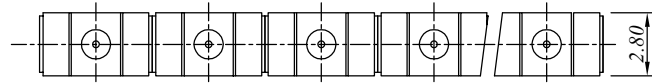

N=Number of contacts

材质于电镀 / Material

塑件 / Insulator body:

PBT, UL94V-0

焊针 Pin header:

Brass, Tin plated

电器性能 / Electrical

参考标准 / Standard:

UL IEC

额定电压 / Rated voltage:

300V 250V

额定电流 / Rated current:

10A 18A

接触电阻 / Contact resistance:

20m Ω (max)

绝缘电阻 / Insulation resistance:

500M Ω / 500V

耐电压 / Withstanding voltage:

AC 2000V/1Min

机械性能 / Mechanical

扭矩 / Torque:

/

温度范围 / Temperature range:

-40°C to +120°C

剥线长度 / Strip length:

/

瞬间温度 / Max soldering:

+250°C, for 5 Sec

尺寸 / Dimensions

间距 / Pitch:

3.5mm

极数 / Poles:

2-24P

慈溪万海电子有限公司

CIXI WANHAI ELECTRONICS CO., LTD.

PART. NAME: JM332J-5.0-XXP

TITLE:

PART. NO.:

DWG NAME:

APPROVED BY

CHECKED BY

DESIGNED BY

DRAWN BY

CUSTOM NO.:

Tolerance

x. ±0.50

x.x ±0.30

x.xx ±0.10

xx° ±1°



UNITS: mm

SCALE: 4/1

REVISION: B3